



INSTRUCTION BULLETIN

No. 340099
Machine: 8200/8210
Published: 12-97/00
System: CHASSIS

NOTE: DO NOT DISCARD the Parts List from the Instruction Bulletin. Place the Parts List in the appropriate place in your machine manual for future reference. Retaining the Parts List will make it easier to reorder individual parts and will save you the cost of ordering an entire kit.

NOTE: Numbers in parenthesis () are reference numbers for parts listed in Bill of Materials.

Installation Instructions for Kit number 365018

SYNOPSIS / PROBLEM:

This kit contains the parts needed to install a solid rear drive tire and wheel assembly on the model 8200/8210 sweeper/scrubber.

Please follow step-by-step instructions.

SPECIAL TOOLS / CONSIDERATIONS: None

(Estimated time to complete: .5 hours)

PREPARATION:

(Refer to FIG. 1)

FOR SAFETY: Before leaving or servicing machine, stop on level surface and set parking brake. Then turn off machine and remove key.

1. Jack up the rear of the machine. Use jack stands to support machine.

FOR SAFETY: Block machine tires before jacking machine up. Jack machine up at designated locations only. Block machine up with jack stands.

2. Turn the rear wheel for access to the wheel nuts. (Refer to FIG. 1)
3. Remove the five wheel nuts from the tire and wheel assembly. (Refer to FIG. 1)
4. Remove the rear tire and wheel assembly from the drive motor hub. (Refer to FIG. 1)
5. Install the new solid rear tire (1) onto the drive motor hub. (Refer to FIG. 1)
6. Reinstall the five wheel nuts and tighten to 122-150 Nm (90-110 ft lb). (Refer to FIG. 1)
7. Remove the jack stands and lower the machine.

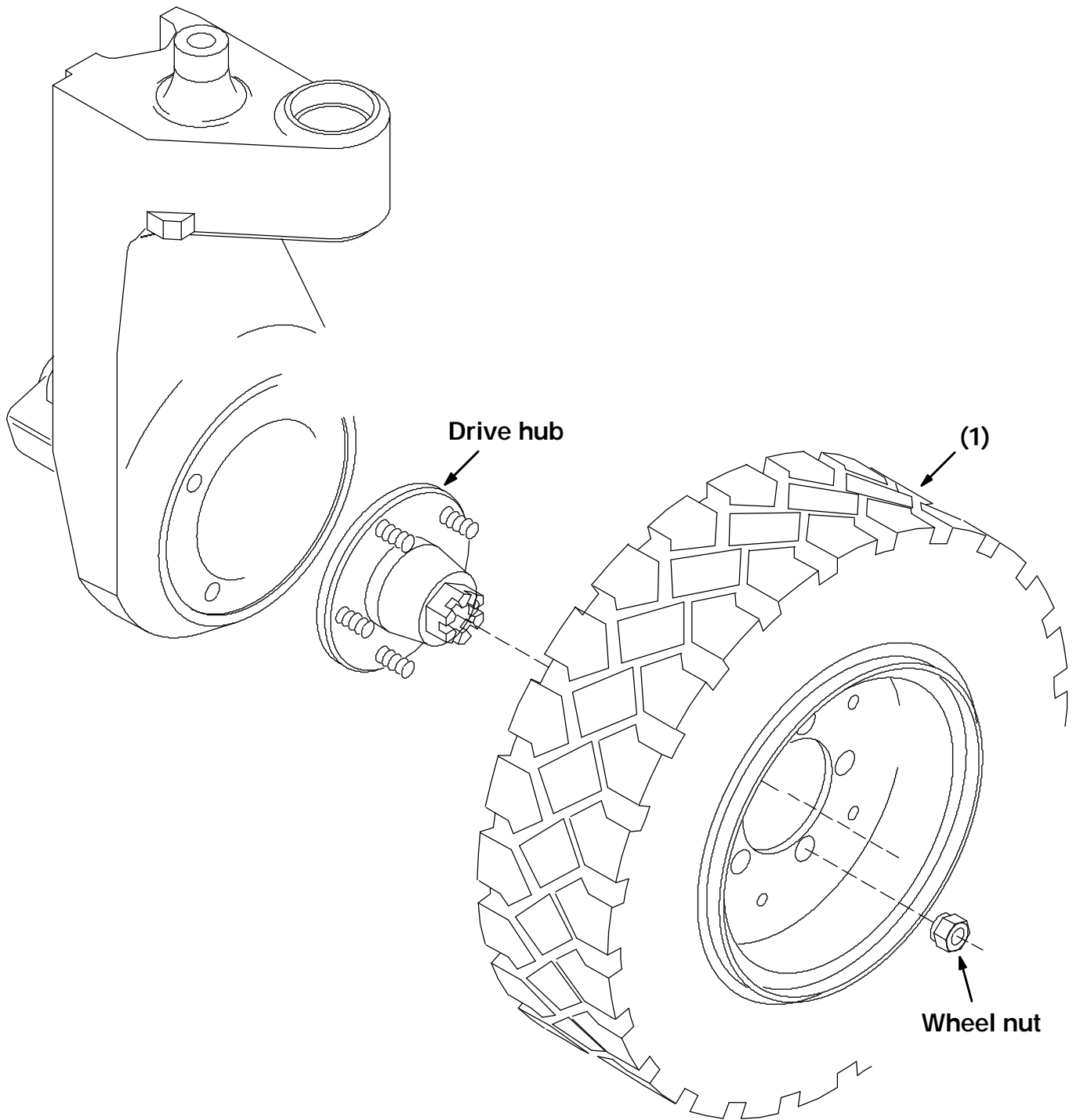

FIG. 1 - Tire Assembly
BILL OF MATERIALS FOR SOLID REAR TIRE KIT 365018

Ref.	TENNANT Part No.	Description	Qty.
1	365020	Solid rear tire	1

TENNANT COMPANY
P. O. Box 1452
Minneapolis, MN 55440-1452