



## INSTRUCTION BULLETIN

No. 340047  
Machine: 6400 G/LP LIQUID  
Published: 4-97/00  
System: ENGINE

**NOTE: DO NOT DISCARD the Parts List from the Instruction Bulletin. Place the Parts List in the appropriate place in your machine manual for future reference. Retaining the Parts List will make it easier to reorder individual parts and will save you the cost of ordering an entire kit.**

*NOTE: Numbers in parenthesis ( ) are reference numbers for parts listed in Bill of Materials.*

Installation Instructions for Kit number 366090.

### SYNOPSIS / PROBLEM:

This kit contains the parts needed to replace the starter assembly on liquid-cooled gas and LP model 6400 sweepers (for all machines with serial number 1190 and below).

Please follow step-by-step instructions.

**SPECIAL TOOLS / CONSIDERATIONS:** Tap handle. Swivel headed magnet.

(Estimated time to complete: 1 hour).

### INSTALLATION OF STARTER ASSEMBLY:

(Refer to FIG. 1)

1. Raise the seat support.

**FOR SAFETY: Before leaving or servicing machine, stop on level surface and set parking brake. Then turn off machine and remove key.**

2. Disconnect the battery cables from machine.



**WARNING: Always disconnect battery cables from machine before working on electrical components.**

3. Locate the starter (on operator side of engine, bolted to the bell housing).
4. Remove and retain top mount screw and nut. (Refer to FIG. 1)
5. Remove and discard bottom mount screw. The nut and split washer will fall inside the bell housing when screw is removed. Retrieve and discard nut and split washer. (Refer to FIG. 1)

*NOTE: Try placing a magnet over the starter opening and using forced air through the timing hole from the other side of the bell housing to retrieve nut and washer. Otherwise, the bell housing may have to be loosened and separated from the bell housing backing plate to retrieve washer and nut.*

6. Tap the bottom mount hole in backing plate to M10-1.5 using thread tap (3) provided. (Refer to FIG. 1)
7. Install the new starter (1) by placing the new screw (2) through the bottom starter mount hole and into the tapped hole. Use the existing screw and nut retained in step 4 in the top starter mount hole. Tighten all hardware. (Refer to FIG. 1)
8. Reconnect battery cables.
9. Lower seat support.

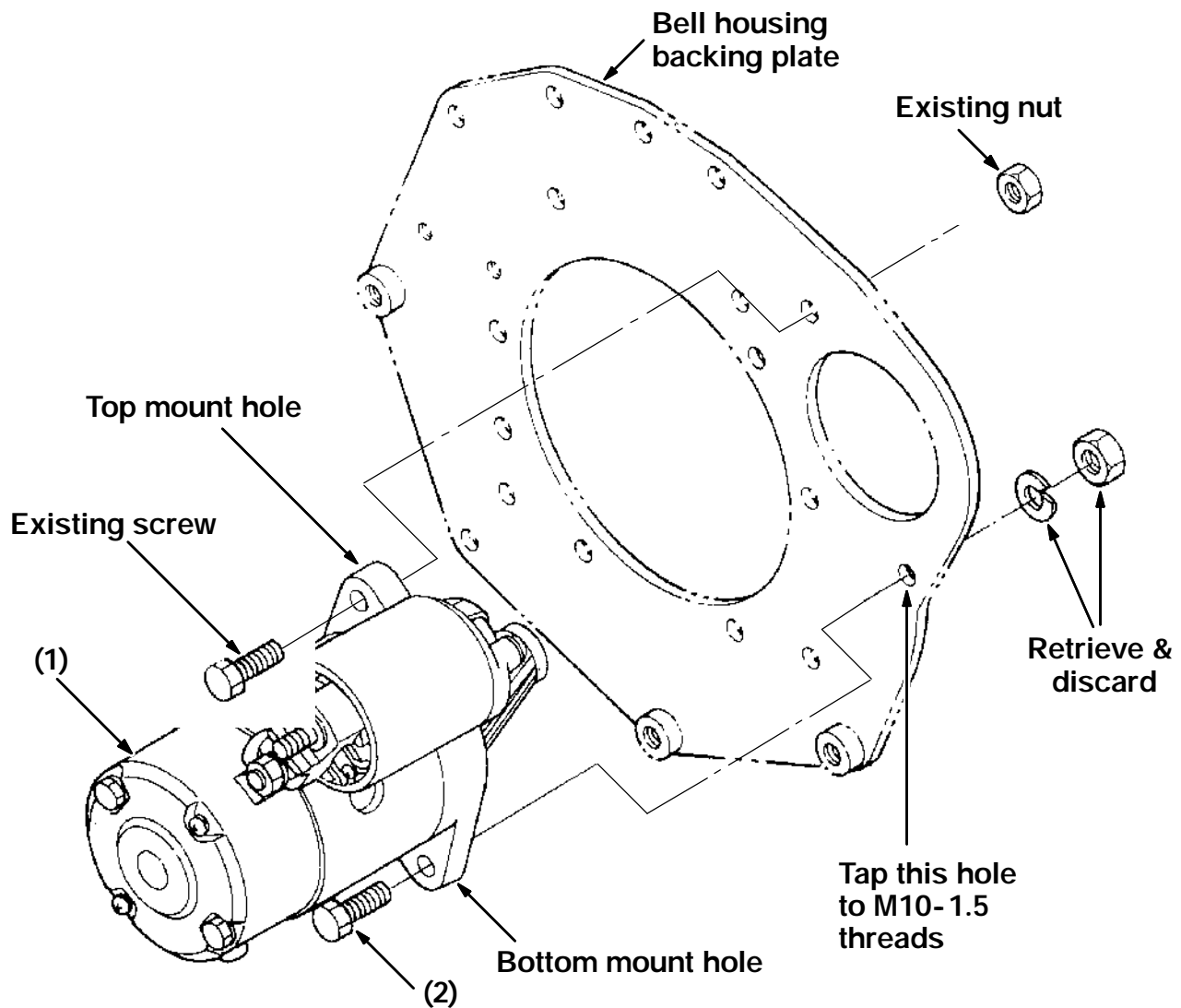

FIG. 1 - Replacement of Starter Assembly on Model 6400 Liquid-Cooled Gas and LPG Machines

# BILL OF MATERIALS FOR STARTER ASSEMBLY KIT 366090

Ref.	TENNANT Part No.	Description	Qty.
1	366089	Starter assembly, rework	1
2	39283	Screw, hex M10X1.5	1
3	366095	Thread tap M10-1.5	1

TENNANT COMPANY  
P. O. Box 1452  
Minneapolis, MN 55440-1452