



# INSTRUCTION BULLETIN

No. 340016  
Machine: 515/515SS  
Published: 10-96/00  
System: SCRUBBING

**NOTE: DO NOT DISCARD the Parts List from the Instruction Bulletin. Place the Parts List in the appropriate place in your machine manual for future reference. Retaining the Parts List will make it easier to reorder individual parts and will save you the cost of ordering an entire kit.**

*NOTE: Numbers in parenthesis ( ) are reference numbers for parts listed in Bill of Materials.*

Installation Instructions for Kit number 363540

## **SYNOPSIS / PROBLEM:**

This kit contains the parts needed to install an auto water shut-off on the model 515/515SS scrubber.

Please follow step-by-step instructions.

## **SPECIAL TOOLS / CONSIDERATIONS:** None

(Estimated time to complete: 2 hours)

## **INSTALLATION:**

(Refer to FIG. 1 and 2)

1. Drain the solution tank.

**FOR SAFETY: Before leaving or servicing machine, stop on level surface and set parking brake. Then turn off machine and remove key.**

2. Open the machine cover and disconnect battery cables from machine.



**WARNING: Always disconnect battery cables from machine before working on electrical components.**

3. Loosen the worm drive clamp holding the hose leading from the solution tank to the front of the existing manual water valve. Remove the hose from the valve fitting. Remove the fitting. (Refer to FIG. 1)
4. Install the new straight fitting (8) in place of the one removed in step 3. (Refer to FIG. 1)
5. Install one hose (6) and one clamp (9) on the new fitting (8). Tighten clamp. (Refer to FIG. 1)
6. Install the large end of the reducer fitting (7) in the end of the solution hose removed in step 3. Install one clamp (9) and tighten. (Refer to FIG. 1)
7. Install the second hose (6) and clamp (9) on the small end of the reducer fitting (7). Tighten clamp. (Refer to FIG. 1)
8. Install the solution valve mount bracket (2) on the machine frame using two hex screws (3), four washers (4), and two hex nuts (5). Tighten firmly. (Refer to FIG. 1)
9. Install the water valve (1) on the mount bracket (2) using two hex screws (3), four washers (4), and two hex nuts (5). Tighten firmly. (Refer to FIG. 1)

10. Install the two new hoses (6) on the two ports of the water valve (1). Install two clamps (9) and tighten. (Refer to FIG. 1)
11. Remove the cover from the electrical control box. (Refer to FIG. 2)

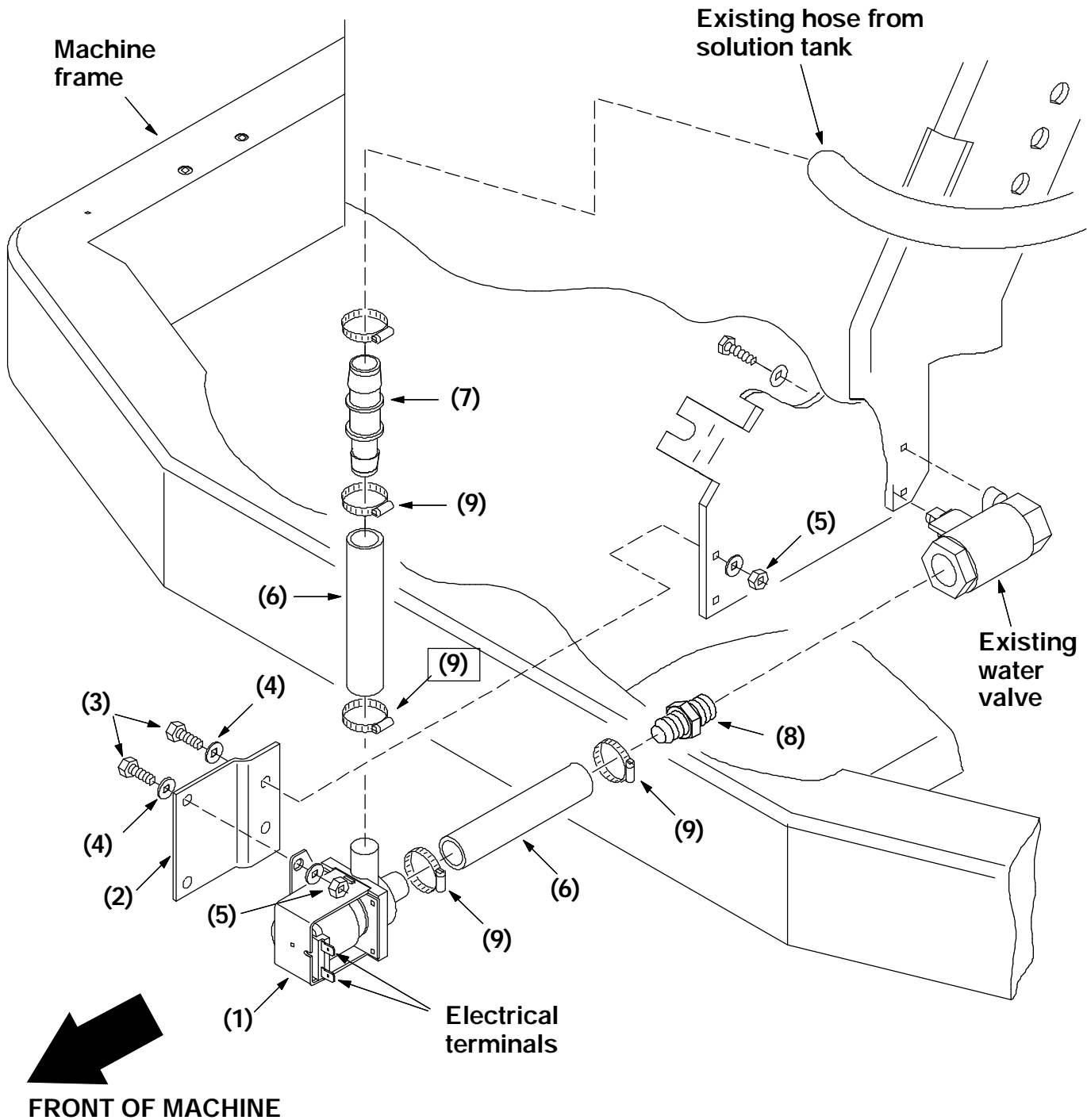

**FIG. 1 - Water Valve Assembly**

12. Locate the M2 brush motor contactor. Connect the 36AA/blu wire from the jumper harness (10) to the positive terminal on the M2 brush contactor and the 46/brn wire from the jumper harness (10) to the negative terminal on the M2 brush contactor. (Refer to FIG. 2)
13. Push the other end of the jumper harness (10) through one of the openings in the back of the electrical control box. (Refer to FIG. 2)

14. Route the jumper harness (10) along the machine frame and down along the solution hose to the water valve. Choose a route that keeps the jumper harness away from the movement of the front tire and any other moving components. The solution hose must also be kept clear of the front tire.

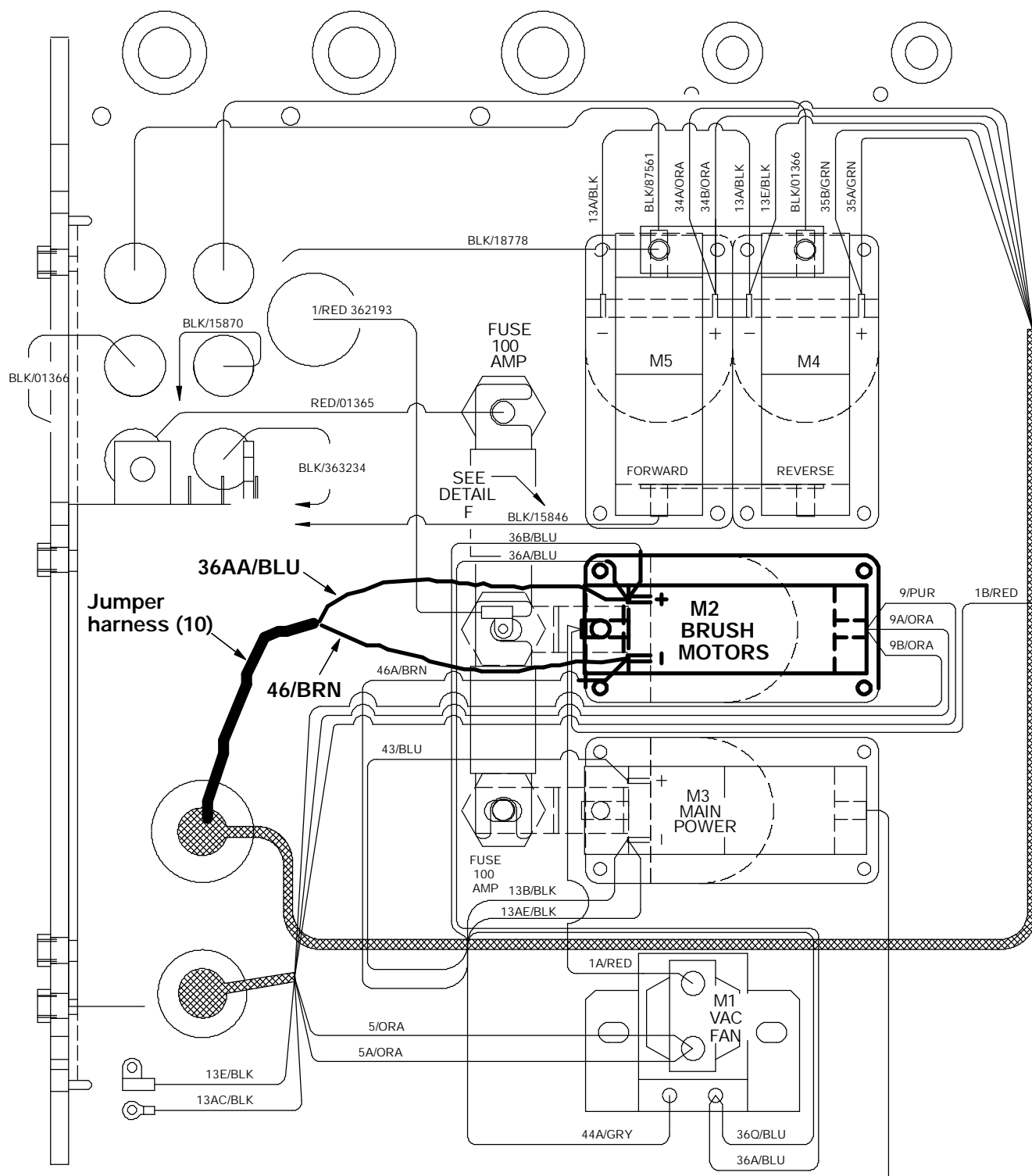

**FIG. 2 - Control Panel Electrical Connections**

15. Connect the jumper harness (10) to the water valve electrical terminals. (Refer to FIG. 1)
16. Reinstall the cover on the electrical control box. Reconnect the batteries.
17. Operate the machine and check the water valve for proper operation.

**BILL OF MATERIALS FOR AUTO WATER SHUT-OFF KIT 363540**

<b>Ref.</b>	<b>TENNANT Part No.</b>	<b>Description</b>	<b>Qty.</b>
1	84028	Water valve	1
2	363489	Water valve mount bracket	1
3	09007	M6 hex screw, 25mm	4
4	32490	1/4" flat washer	4
5	08712	M6 nyloc nut	4
6	363522	Heater hose, 5/8" id x 4-1/2" L	2
7	363543	Reducer fitting, 5/8" - 3/4"	1
8	71628	Plastic fitting, straight, 3/4"	1
9	86824	Worm drive clamp	4
10	363539	Jumper harness	1

TENNANT COMPANY  
P. O. Box 1452  
Minneapolis, MN 55440-1452