



## INSTRUCTION BULLETIN

No. 340015  
Machine: 6400 G - L/C  
Published: 10-96/00  
System: ENGINE

**NOTE: DO NOT DISCARD the Parts List from the Instruction Bulletin. Place the Parts List in the appropriate place in your machine manual for future reference. Retaining the Parts List will make it easier to reorder individual parts and will save you the cost of ordering an entire kit.**

*NOTE: Numbers in parenthesis ( ) are reference numbers for parts listed in Bill of Materials.*

Installation Instructions for Kit number 361920.

### SYNOPSIS / PROBLEM:

This kit contains the parts needed to replace the fuel hose on the model 6400 G - L/C sweeper.

Please follow step-by-step instructions.

**SPECIAL TOOLS / CONSIDERATIONS:** Large Side Cutter.

(Estimated Time to complete: 1 hour)

**FOR SAFETY:** Before leaving or servicing machine, stop on level surface and set parking brake. Then turn off machine and remove key.

### INSTALLATION OF REPLACEMENT FUEL HOSE:

(Refer to FIG. 1 and 2)

1. Raise seat support.
2. Place drain pan under fuel hose area to catch possible fuel leaks.

**FOR SAFETY:** Keep flames and sparks away from fuel system service area (gasoline, lpg, diesel). Keep area well ventilated.

3. Remove and discard existing fuel hose.
4. Install new fuel hose (1). (Refer to FIG. 2)

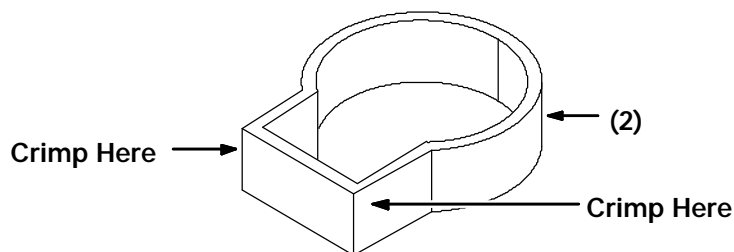

**FIG. 1 - Crimping of Fuel Hose Clamp**

5. Secure fuel hose by tightening flare nut and clamp (2). Use *only* the clamp provided.
6. Tighten clamp (2) by crimping sides of raised area with a side cutter. (Refer to FIG. 1)
7. Lower seat support.

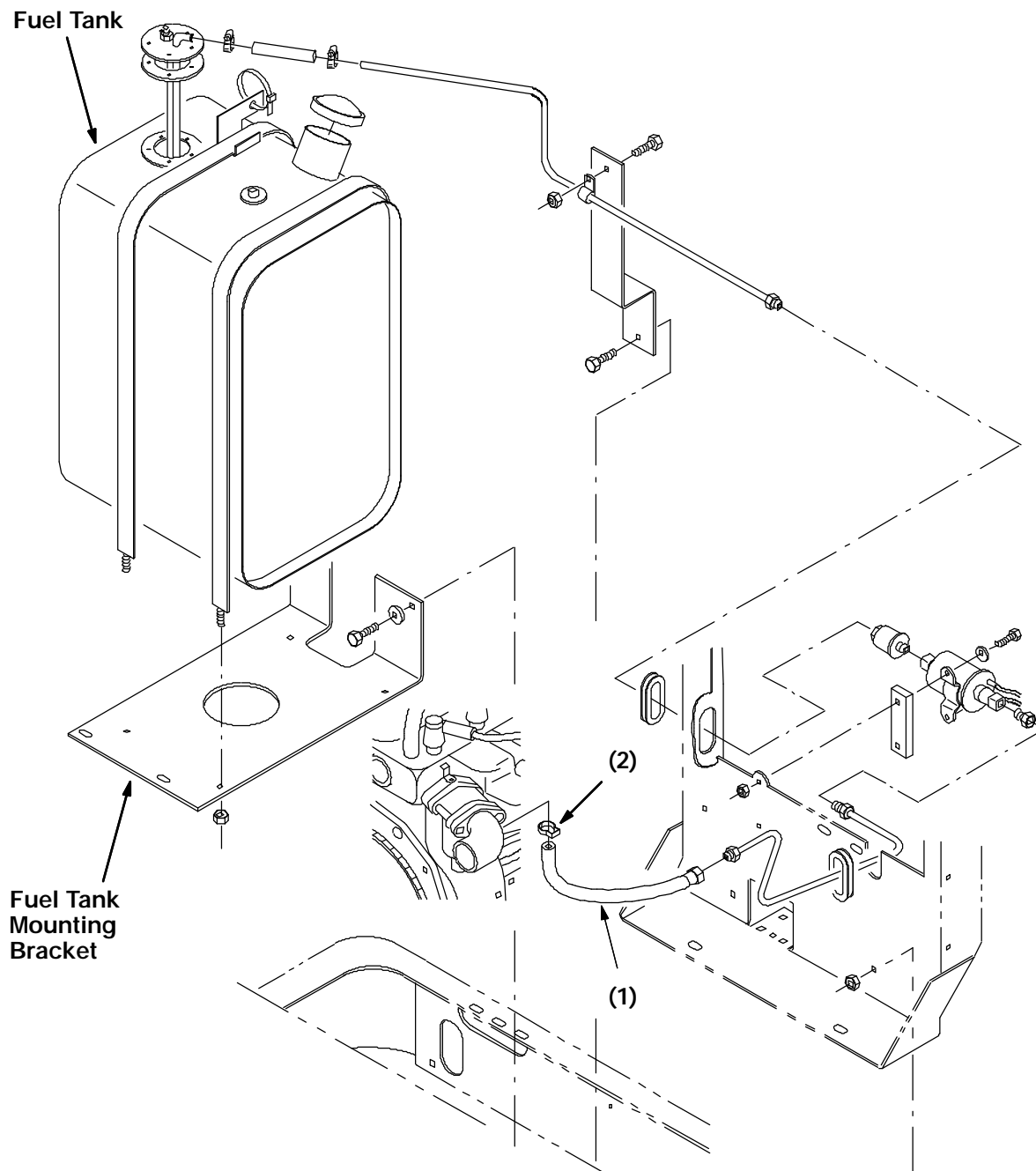

**FIG. 2 - Installation of Replacement Fuel Hose**

**BILL OF MATERIALS FOR FUEL HOSE REPLACEMENT KIT NUMBER 361920**

Ref.	TENNANT Part No.	Description	Qty.
1	361338	Fuel Hose	1
2	361552	Clamp	1

TENNANT COMPANY  
P. O. Box 1452  
Minneapolis, MN 55440-1452