



# SQUEEGEE LIFT/SWIVEL RETROFIT KIT

## SQUEEGEE LIFT HANDLE INSTALLATION INSTRUCTIONS:

**TOOLS REQUIRED:** Wrench sizes: 1/2, (2) 17mm, (2) 10mm, 5.5mm & Standard Screw Driver. **(Installation: 1/2 hour)**

**FOR SAFETY:** Before installing kit, disconnect positive (+) battery cable from batteries. (1/2" wrench)

**A.** Remove electrical panel cover (4 screws).

**B.** Remove old squeegee lift handle assembly.

**C.** Remove two spacers between switch and panel wall, then refasten switch. Use existing hardware.

### SQUEEGEE LIFT HANDLE PARTS LIST

Ref.	P/N.	Description	Qty.
	190751	Kit, Squeegee Lift/Swivel	1
1	601094000	Screw, Hex M10x45mm	1
2	140036	Washer, Flat	2
3	059650290	Washer, Nylon	2
4	140285	Nut, Hex M10x1.5	1
5	140333	Washer, Split Lock	1
6	41430	Nut, Hex Lock M10	1
7	630426	Pulley, Cable	1
8	626146	Bracket, Switch	1
9	578580	Screw, Hex M06x35mm	1
10	626047	Spacer	1
11	579210	Washer, Flat	3
12	08708	Nut, Hex Lock	1
13	231071	Handle, Squeegee Lift	1
14	630209	Grip, Handle	1

**E.** Assemble squeegee lift handle as shown.

**D.** Knock out pressed in nut with punch and hammer.

**F.** Before reinstalling lift handle, make sure squeegee lift bracket is vertically straight up and down.

**H.** Do not tighten nut up against handle, leave a little play to allow handle to engage lift hook.

**G.** Attach new squeegee lift handle assembly as shown.



# SQUEEGEE LIFT/SWIVEL RETROFIT KIT

## SQUEEGEE SWIVEL INSTALLATION INSTRUCTIONS:

(Installation: 1 1/2 hours)

**TOOLS REQUIRED:** Wrench sizes: (2) 9/16", (2) 13mm, (2) 10mm, 11mm, (2) 1/2" & Right Angle Drill & 1/2" Bit.

**A.** Remove pad/brush drivers from scrubber head.

**B.** Remove defective squeegee bracket assembly from machine. To access where squeegee bracket assembly is attached to frame weldment bracket, lower scrubber head to floor and remove red cap from scrubber head. Use two 9/16" wrenches to remove assembly. Cable also must be disconnected.

**C.** Raise scrubber head. With a right angle drill, drill out holes to 1/2" in frame weldment bracket.

*NOTE: To drill with standard drill, remove batteries and carefully lay machine on its side.*

**D.** Disassemble defective squeegee bracket assembly and reassemble it using replacement parts from kit as shown. **Be certain to use all kit replacement parts.** Replacement parts are labeled with numbers. Reassemble assembly before reinstalling. Use existing hardware.

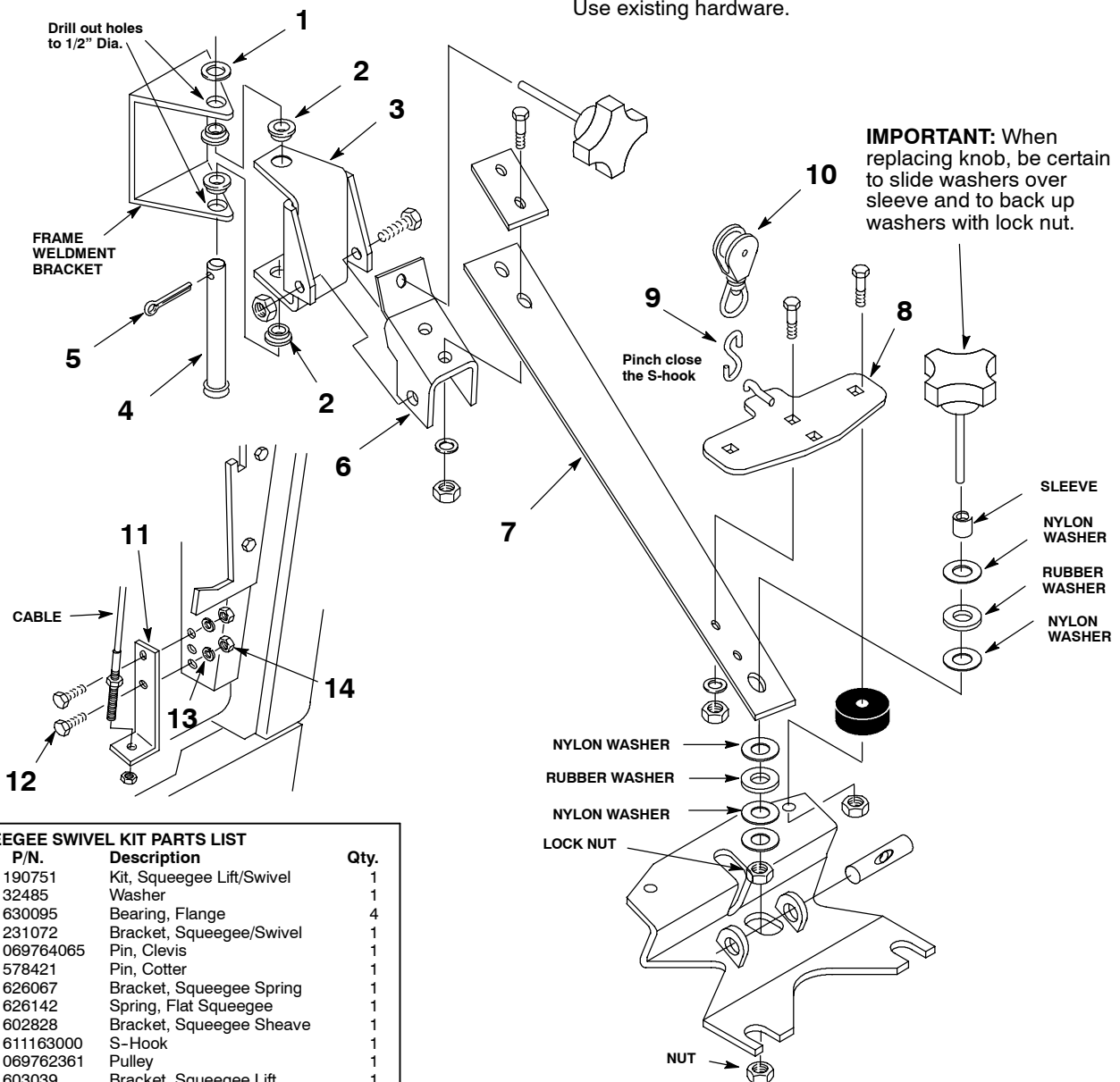

### SQUEEGEE SWIVEL KIT PARTS LIST

Ref.	P/N.	Description	Qty.
	190751	Kit, Squeegee Lift/Swivel	1
1	32485	Washer	1
2	630095	Bearing, Flange	4
3	231072	Bracket, Squeegee/Swivel	1
4	069764065	Pin, Clevis	1
5	578421	Pin, Cotter	1
6	626067	Bracket, Squeegee Spring	1
7	626142	Spring, Flat Squeegee	1
8	602828	Bracket, Squeegee Sheave	1
9	611163000	S-Hook	1
10	069762361	Pulley	1
11	603039	Bracket, Squeegee Lift	1
12	200031436	Screw, M6x1.0x16	1
13	140016	Washer, Lock	1
14	07785	Nut, M6	1