



# Replacement Gearbox Kit

For Models: R14 / Strive Rider



## INSTALLATION NOTICE

Terminal connectors must be installed on the new brake as described.

**TOOLS REQUIRED:** Wire Cutters, Wire Stripper, and Crimper Tool.

1. Cut the brake wire at the described length.

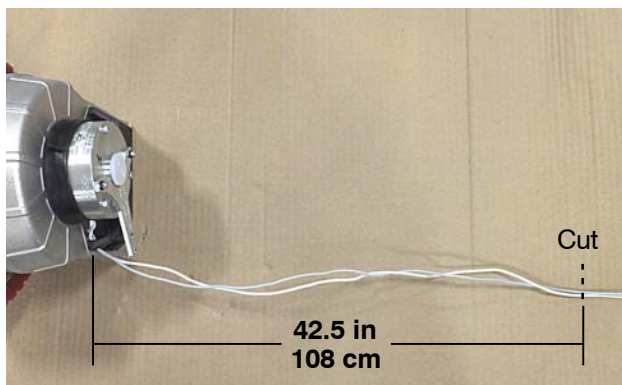

2. BEFORE ATTACHING WIRE CONNECTOR TERMINALS, install new gearbox assembly and route the brake wires through the machines wire harness sleeve.
3. After brake wire is properly routed, strip brake wires as shown. Using the Packard crimping tool, install new terminals and seals to wires as shown.

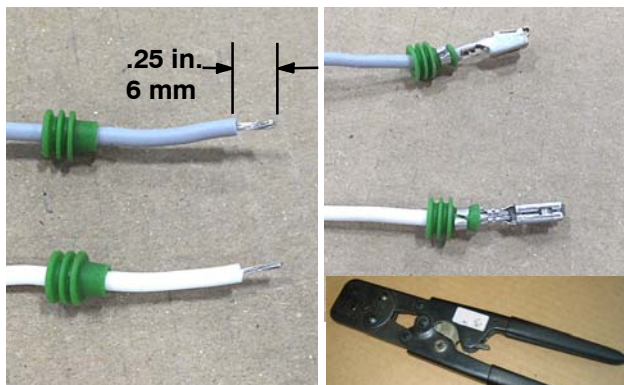

Crimper Tool - Packard Part No. 12155975

## KIT CONTENTS

P/N	DESCRIPTION	QTY.
1024247	GEARBOX, WHEEL, 250CMM, 1200W	1
78950	CONNECTOR, FEM, 2CAV	1
78952	LOCK, SECONDARY, M/F 2CAV	1
25837	TERMINAL, FEM 20/22GA	2
25830	SEAL, WIRE 14GA	2

4. Connect brake wires to new connector as shown (*non-polarity sensitive*). Wire terminals should snap into position.

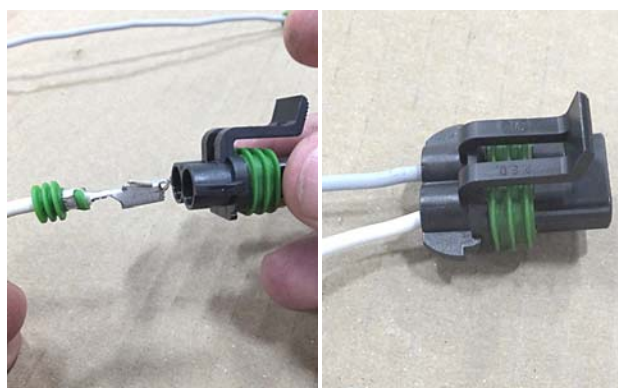

5. Install secondary lock.

