

Date:
September 26, 2014

Technical Service Bulletin

MODEL(S) AFFECTED: **Following models equipped with Emergency Stop Button**
Manufactured between serial number range 10697300- 10708400 (July 10 - Sept 3, 2014):
SpeedGleam 5, SpeedGleam 7, SpeedGleam Rider, Strive, Strive Rider, Speed Scrub 17/20 (SS3), Speed Scrub 24/32 (SS5) and Speed Scrub Rider

SUBJECT: Functional issue with emergency stop button (Design B). When pressed, the button may not remain engaged in the lock-out position as designed. In this condition, the switch will still disable machine when pressed, but the button must be held for one to two seconds on some models such as the Speed Scrub 24/32 (SS5), Speed Scrub Rider and Strive Rider.

PURPOSE: For machines equipped with emergency stop button (Design B), it's recommended to replace with emergency stop button (Design A) p/n 1011735.

NOTES: **Warranty Information:** Standard warranty terms apply. When servicing machine on a non-related issue, also replace emergency stop button.

Emergency Stop Button (Design B)

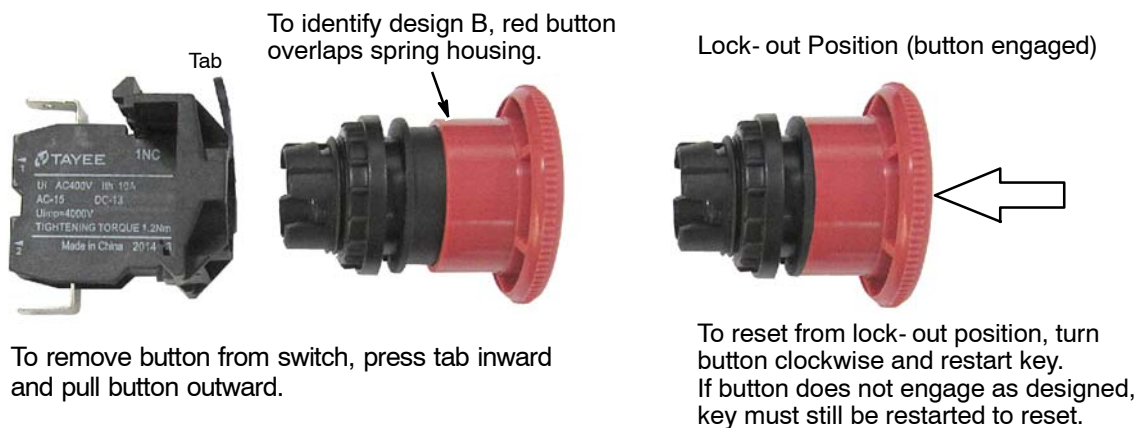

Replace with Emergency Stop Button, p/n 1011735 (Design A)



Note: Both emergency stop button designs share the same part number, confirm correct design before installing. Emergency stop button (Design B) has been removed from inventory.